







Capacities

The ATLANTIC Hotel Wilhelmshaven has nine conference rooms accommodating 10 to 250 persons, among them the ballroom with up to 256 places, and three board rooms,

	sqm	Maximum number of persons						Room dimensions		
								Length	Width	Height
Wilhelmshaven I+II	291	256	151	51	180	51	225	24,20	12,02	5,00
Wilhelmshaven I oder II	145	110	60	27	80	27	100	12,10	12,02	5,00
Travemünde I	76	60	30	23	40	23	50	12,50	6,05	4,36
Travemünde II	53	30	15	13	/	13	25	8,82	6,05	4,36
Travemünde I+II	129	112	65	41	50	41	80	20,77	6,05	4,36
Bremen I	102	80	42	30	50	30	70	12,65	8,08	4,36
Bremen II	50	30	21	10	/	10	20	6,16	8,08	4,36
Bremen I+II	152	130	72	39	90	39	115	18,81	8,08	4,36
Kiel	24	/	/	/	/	10	/	6,05	3,94	2,54
Münster	33	/	/	/	/	12	/	8,30	3,97	3,09
Lübeck	21	/	/	/	/	8	/	5,01	4,25	3,09

Ballroom Wilhelmshaven I + II

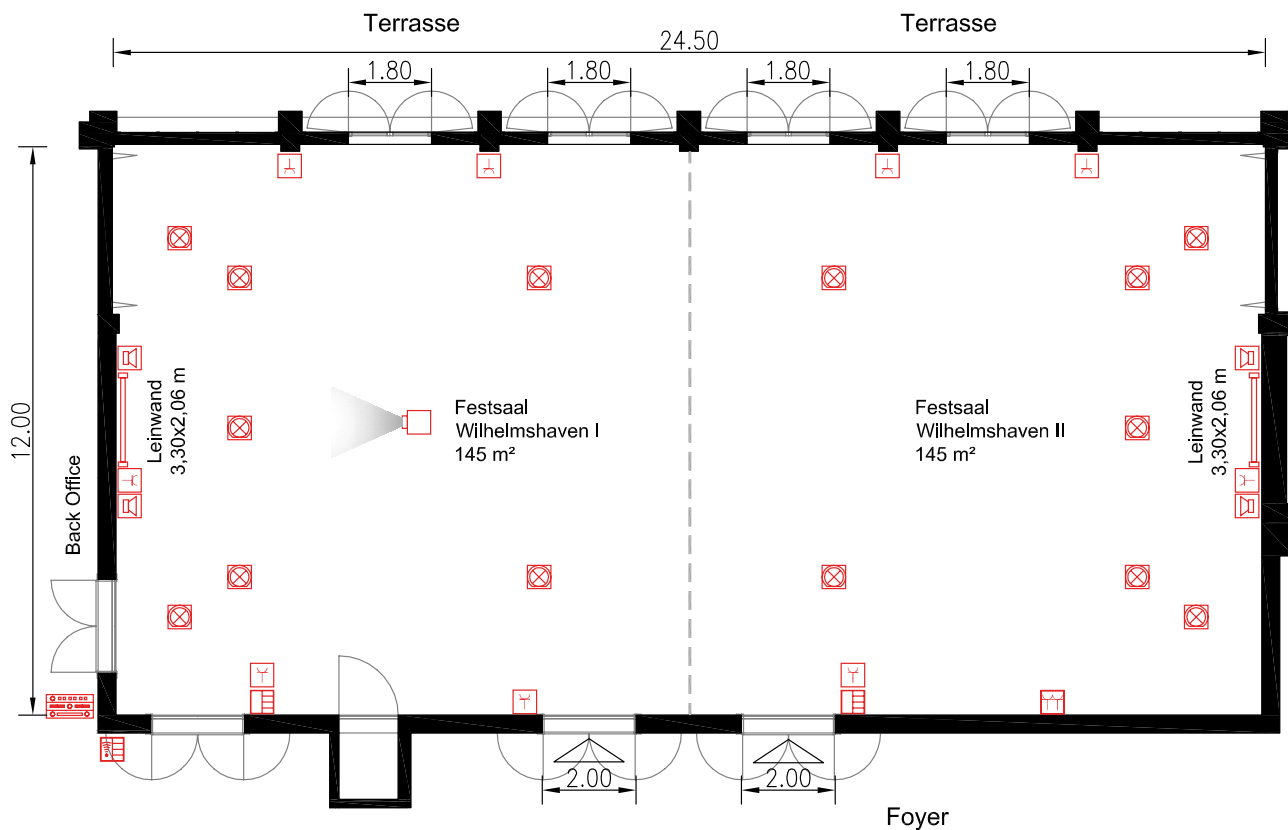

Daylight	✓
Air.conditioned	✓
To be darkened	✓
Accessible by car	✓ (with pressure equalizing plates)
Internet access	WLAN/LAN
Power connection	38 x 220 V / 16A possible (availfromle to room)
Projector	Integrated
TV connection	–
Sound system	✓
Floor covering	Carpet
Location in hotel	Ground floor
Other features	Terrace, floor.to.ceiling windows, 5 m ceiling height

Conference room Travemünde I

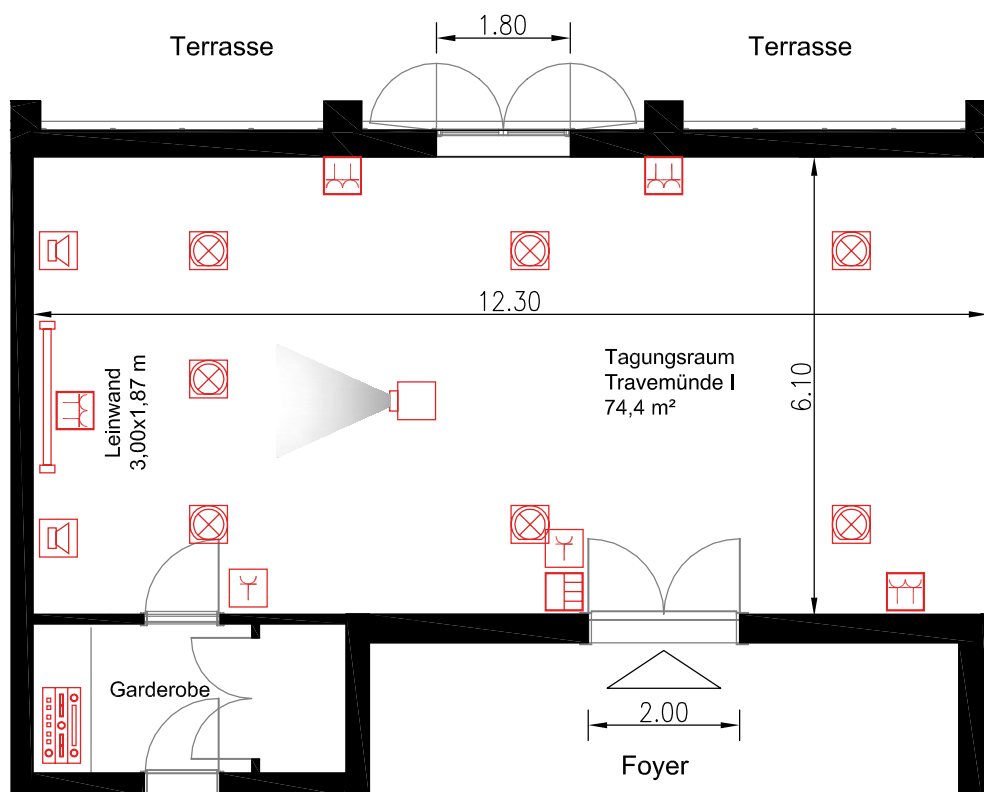

Daylight	✓
Air.conditioned	✓
To be darkened	✓
Accessible by car	–
Internet access	WLAN/LAN
Power connection	38 x 220 V
Projector	Integrated
TV connection	✓
Sound system	✓
Floor covering	Carpet
Location in hotel	Ground floor
Other features	Covered terrace, floor.to.ceiling windows, ceiling height 4,36 m

Conference room Travemünde II

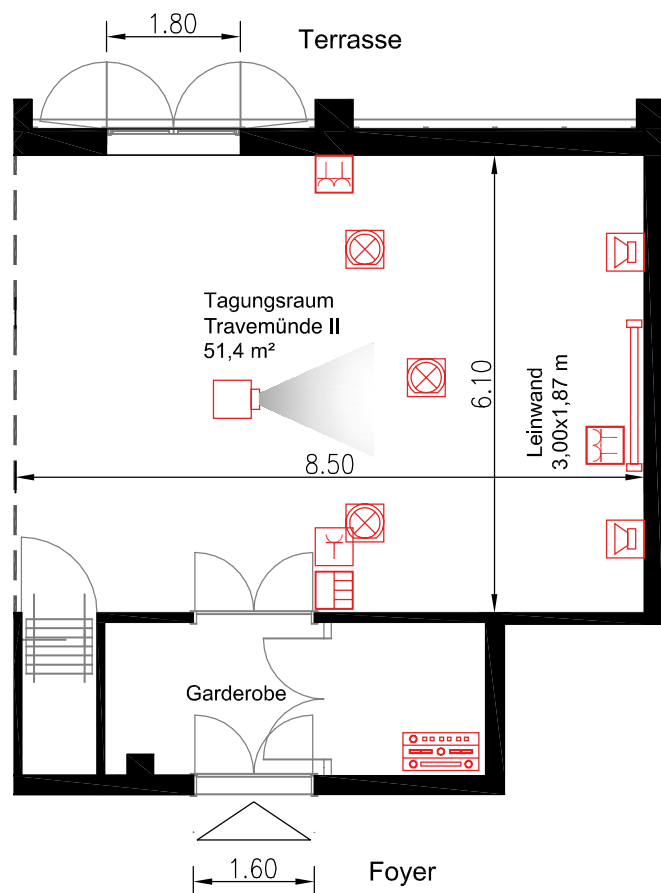

Daylight	✓
Air.conditioned	✓
To be darkened	✓
Accessible by car	–
Internet access	WLAN/LAN
Power connection	23 x 220 V
Projector	Integrated
TV connection	✓
Sound system	✓
Floor covering	Carpet
Location in hotel	Ground floor
Other features	Covered terrace, floor.to.ceiling windows, ceiling height 4,36 m

Conference room Travemünde I + II

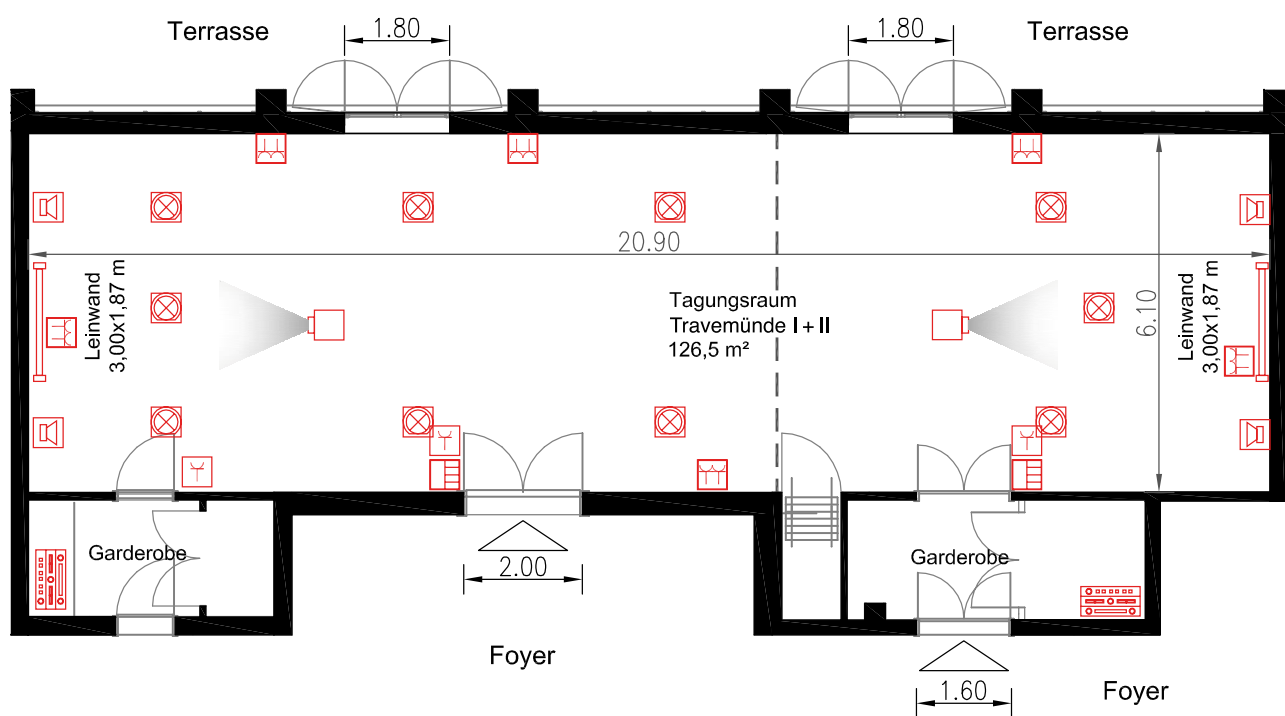

Daylight	✓
Air.conditioned	✓
To be darkened	✓
Accessible by car	–
Internet access	WLAN/LAN
Power connection	61 x 220 V
Projector	Integrated
TV connection	✓
Sound system	✓
Floor covering	Carpet
Location in hotel	Ground floor
Other features	Covered terrace, floor.to.ceiling windows, ceiling height 4,36 m

Conference room Bremen I

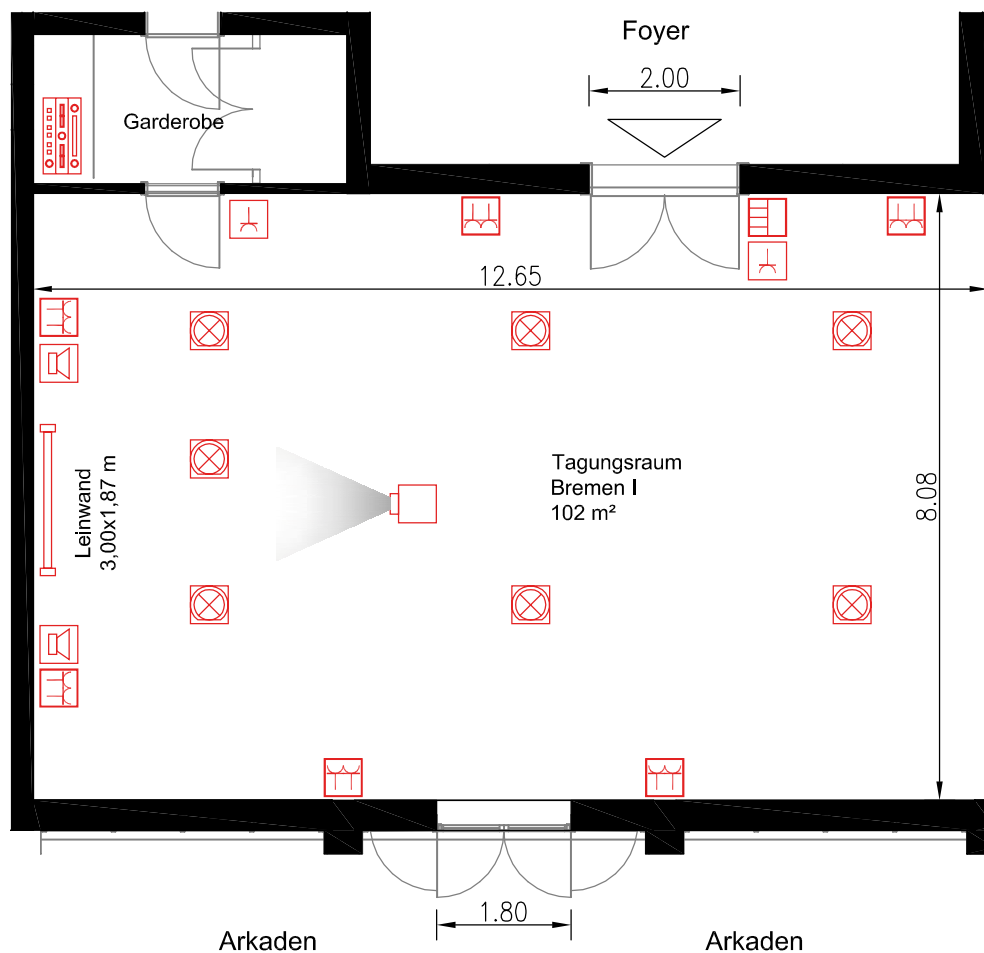

Daylight	✓
Air.conditioned	✓
To be darkened	✓
Accessible by car	–
Internet access	WLAN/LAN
Power connection	42 x 220 V
Projector	Integrated
TV connection	✓
Sound system	✓
Floor covering	Carpet
Location in hotel	Ground floor
Other features	Floor.to.ceiling windows, ceiling height 4,36 m

Conference room Bremen II

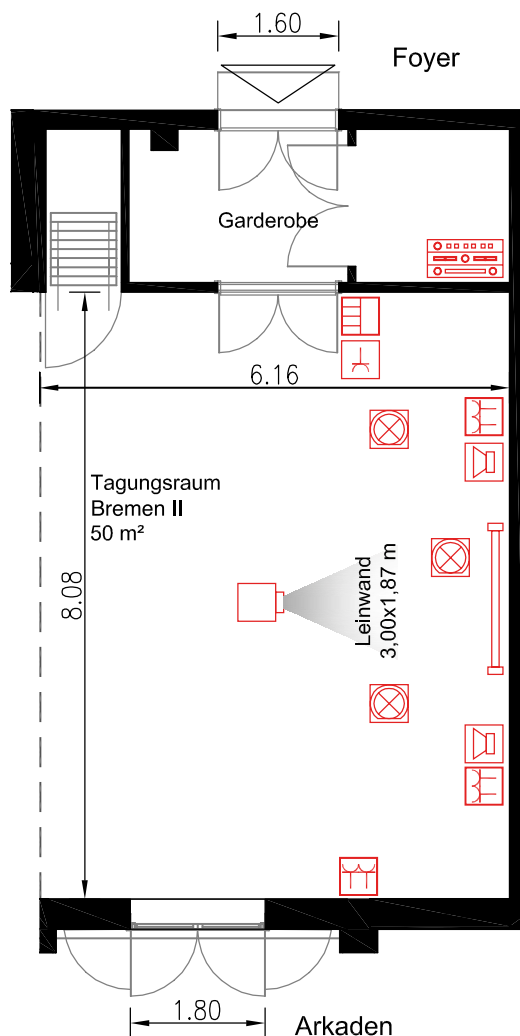

Daylight	✓
Air.conditioned	✓
To be darkened	✓
Accessible by car	–
Internet access	WLAN/LAN
Power connection	15 x 220 V
Projector	Integrated
TV connection	✓
Sound system	✓
Floor covering	Carpet
Location in hotel	Ground floor
Other features	Floor.to.ceiling windows, ceiling height 4,36 m

Conference room Bremen I + II

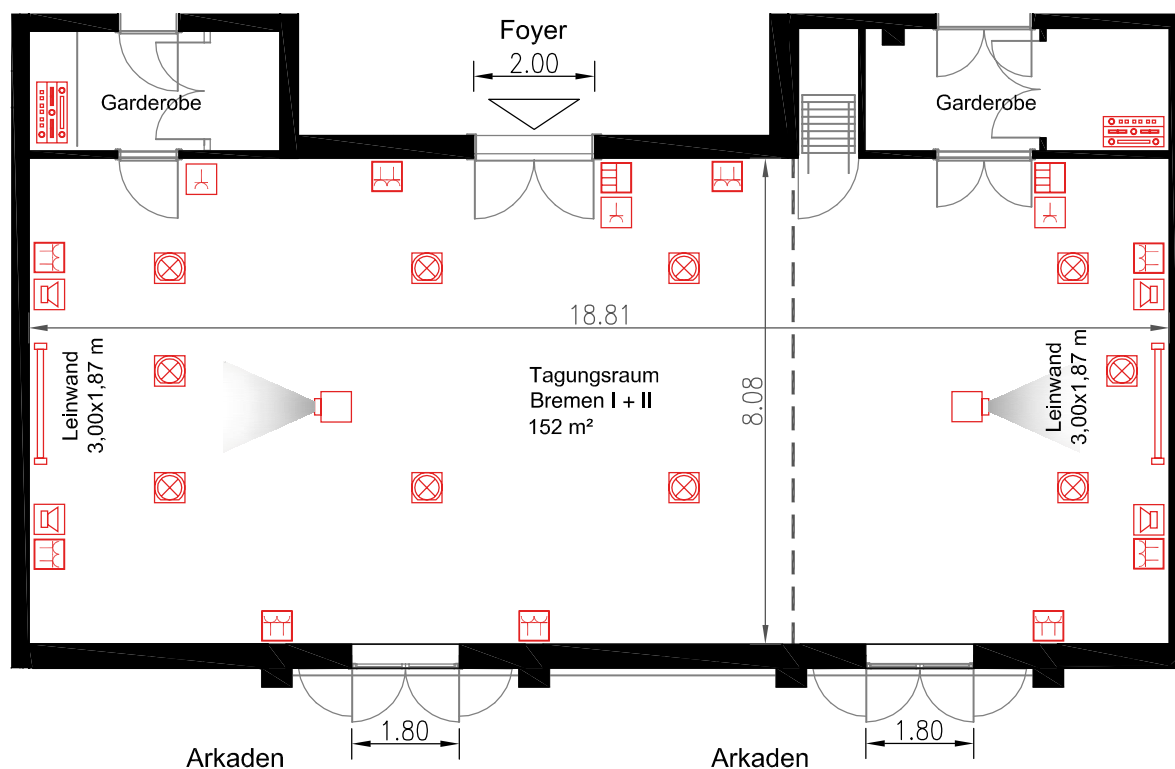

Daylight	✓
Air.conditioned	✓
To be darkened	✓
Accessible by car	–
Internet access	WLAN/LAN
Power connection	57 x 220 V
Projector	Integrated
TV connection	✓
Sound system	✓
Floor covering	Carpet
Location in hotel	Ground floor
Other features	Floor.to.ceiling windows, ceiling height 4,36 m

Board Room Kiel

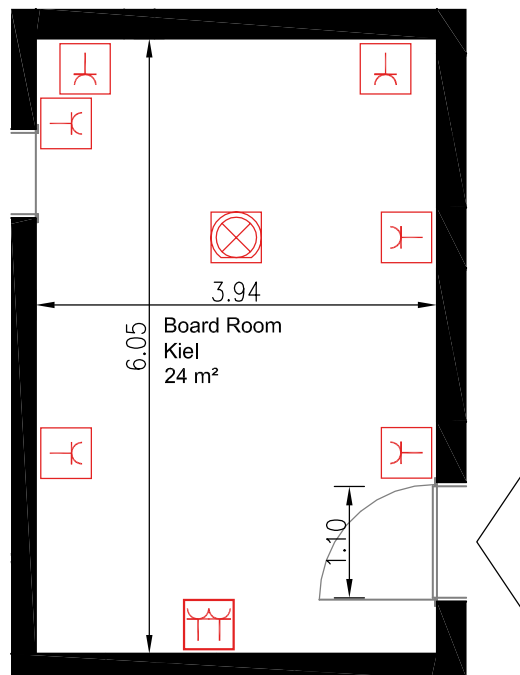

Daylight	Indirect from lobby
Air.conditioned	–
To be darkened	✓
Accessible by car	–
Internet access	WLAN/LAN
Power connection	8 x 220 V
Projector	Mobile
TV connection	–
Sound system	–
Floor covering	Carpet
Location in hotel	Ground floor
Other features	Workstation (PC, printer)

Board Room Münster

Daylight	✓
Air.conditioned	✓
To be darkened	✓
Accessible by car	–
Internet access	WLAN/LAN
Power connection	9 x 220 V
Projector	Mobile
TV connection	–
Sound system	–
Floor covering	Carpet
Location in hotel	First floor
Other features	Private dining, floor.to.ceiling windows

Board Room Lübeck

Daylight	✓
Air.conditioned	✓
To be darkened	✓
Accessible by car	–
Internet access	WLAN/LAN
Power connection	8 x 220 V
Projector	Mobile
TV connection	–
Sound system	–
Floor covering	Carpet
Location in hotel	First floor
Other features	Floor.to.ceiling windows

ROOM COSTS

Clear and transparent ...

Transparency is one of the pillars of the ATLANTIC Hotels' "SMART meetings and events" concept. For this reason, room costs/rentals are not hidden in our conference packages.

If the catering consumption (food and beverages during the event) is less than the stated turnover guarantee per room, we will charge the resulting difference as room provision costs. Technical equipment, if required, may be hired externally and charged separately.

Our room hire charges are calculated according to the following key, unless a conference package has been booked.

	Room size in sqm	Room rental in EUR	Sales guarantee in EUR
Wilhelmshaven I+II	291	from 2,190.00	5,800.00
Wilhelmshaven I oder II	145	from 1,095.00	2,900.00
Travemünde I	76	from 610.00	1,700.00
Travemünde II	53	from 430.00	1,150.00
Travemünde I+II	129	from 1,040.00	2,850.00
Bremen I	102	from 790.00	2,150.00
Bremen II	50	from 390.00	1,100.00
Bremen I+II	152	from 1,185.00	3,250.00
Kiel	21	from 170.00	–
Münster	33	from 170.00	–
Lübeck	24	from 170.00	–